

Sonata 7

Sonata 7

RIGGING SPECIFICATIONS

Mast Height — 7.92 metres (26 ft.)
Boom Length — 2.74 metres (9 ft.)
Mainsail Area — 9.5 sq. metres (102 sq. ft.)
Jib Area — 10.4 sq. metres (112 sq. ft.)
No. 1 Genoa Area — 18.9 sq. metres (203 sq. ft.)
Spinnaker Area — 45.3 sq. metres (488 sq. ft.)

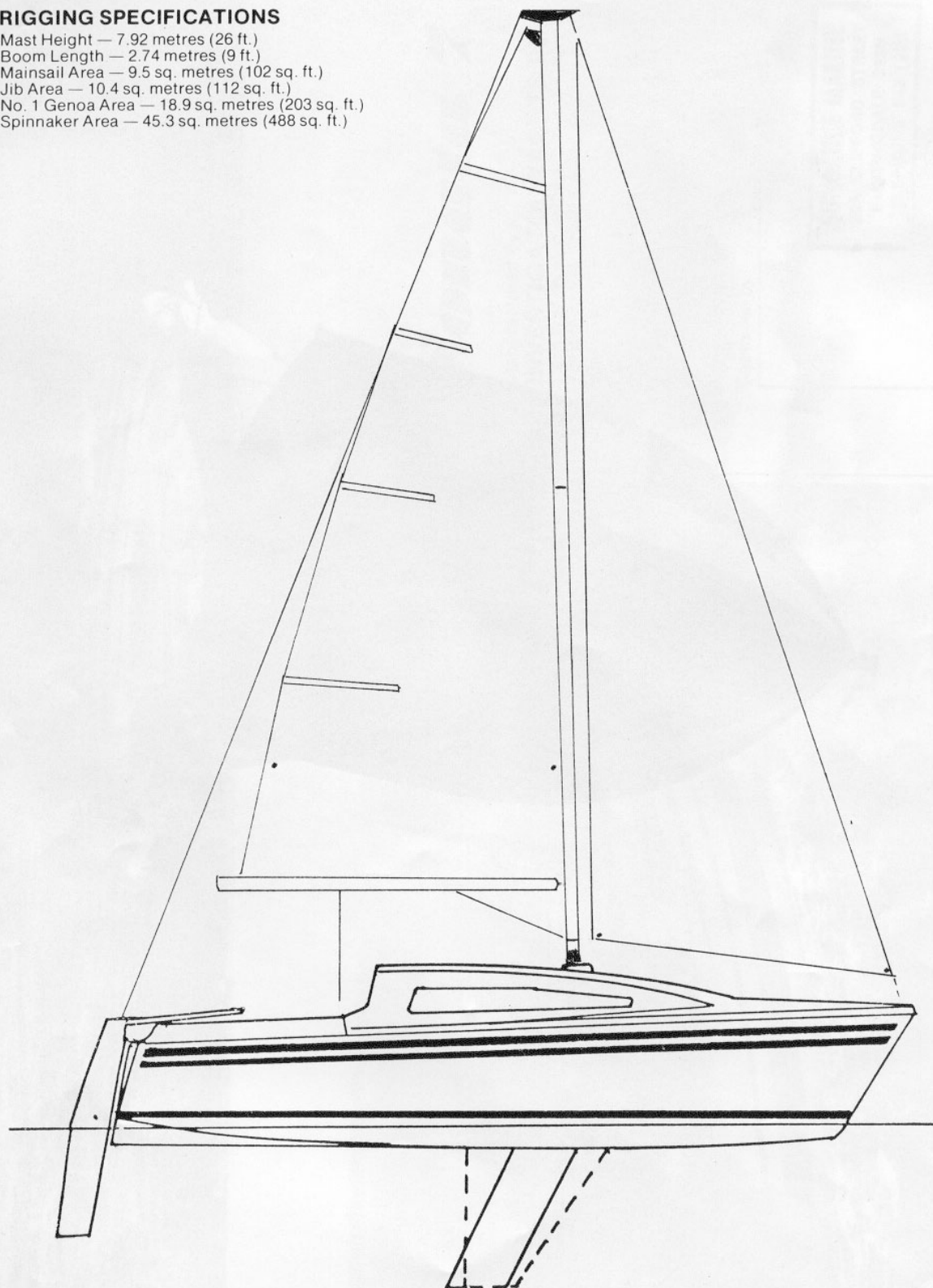

Sonata 7

The Sonata 7 is one of the most comfortable family cruising yachts available in the yachting market today. For a 23 footer it is extremely spacious down below.

Sleeping is provided by six berths and can accommodate an average family in complete comfort.

The separate galley includes built-in ice box, sink, stove compartment and plenty of storage space under.

A separate toilet compartment is much more practical for family use than those which are located under bunks. Storage space is located under all berths and other lockers conveniently placed throughout the yacht.

A large pop top provides standing headroom and plenty of fresh air.

The cockpit is large and self draining. There are lockers built in for fuel tanks, ropes, fenders etc. Small coaming lockers are for small items such as sunglasses, sun lotion etc.

The forehatch is perspex alloy framed for access to the foredeck and anchor well, as well as providing light and ventilation.

The rigging is a simple masthead configuration with all controls leading back to the cockpit which assists greatly when sailing short handed.

The new rudder blade stows vertically in its alloy rudder box for ease of trailering or launching.

The ballasted swing keel retracts fully into the hull requiring just a foot of water to float the yacht.

The fixed fin keel model has proven to be popular with those who prefer to permanently moor their yachts.

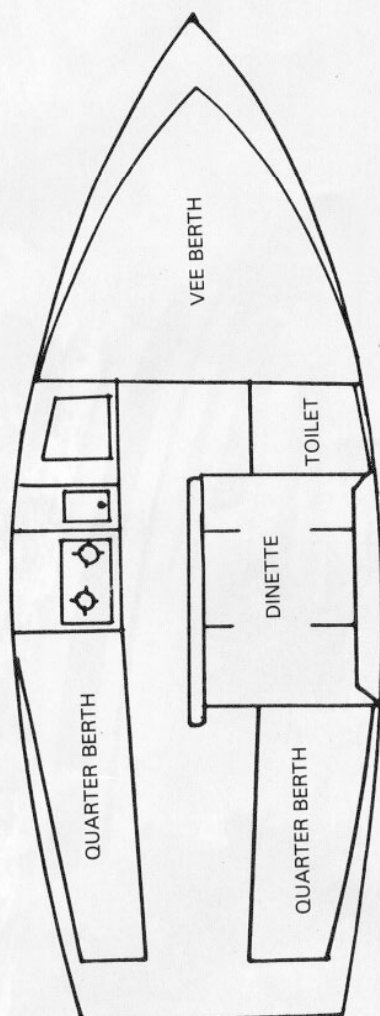

SPECIFICATIONS

L.O.A. — 6.9 metres (22 ft. 9 ins.)
L.W.L. — 5.97 metres (19 ft. 7 ins.)
Beam — 2.45 metres (8 ft. 2 ins.)

Draft

Swing Keel — 0.22 metres (9 ins.)
1.37 metres (4 ft. 6 ins.)
Fin Keel — 1.25 metres (4 ft. 1 in.)

Weight (Sailaway) — 1027 kg. (2260 lbs.)

Ballast — 409 kg. (900 lbs.)

Although all descriptions are believed to be accurate at the time of publication accuracy cannot be guaranteed. Due to continuous product improvements, specifications may change without notice.



Manufactured by:
INVESTIGATOR YACHTS PTY. LTD.
Lot 11, Macquarie Road,
Cardiff, N.S.W. 2285
(049) 54 5303

Distributed by:

SUNDANCE MARINE
28A CLIFFORD STREET
HUNTINGDALE 3166
TELEPHONE 543 1229

SONATA 6.3, 6.7, 7, 26



SUNDANCE

MARINE SALES

26A CLIFFORD ST., HUNTINGDALE, VICTORIA 3166
PHONE (03) 543 1229

July, 1986

SONATA 7

STAGE A - BASIC ASSEMBLY - Hull, deck, furniture moulding and headliner all bonded together. Windows cut out. Anchor well bonded in. Keel and winch fitted with positive lock down, towing eye fitted. All fibreglass hatches, gunwale strips and end caps and rudder blade supplied loose.

..... \$ 12,570

STAGE B - SAILAWAY YACHT - as above but with mast and boom assembled, gunwale strips, windows, hatches, pop-top mechanism, chainplates and main bulkhead fitted. 2 x Barlow 15 halyard winches and 2 x Barlow 16 sheet winches and cleats fitted. Main and jib sheet travellers and cars fitted. Mainsail with 2 reefs, battens and numbers and Jib (North or Hood sails)

..... \$ 17,400

OPTIONAL EXTRAS: (all fitted)

Teak trim (plate rack, pinrail, table, galley bulkhead bunk fiddles)	950
Bunk cushions	740
Trailer, galv.tandem tilt with hyd.disc brakes	2,940
Pulpit, pushpit, stanchions, lifelines and mast supports	780
Carpet to interior of hull	330
Transom boarding ladder	150
Spinnaker pole and accessories	430
Outboard bracket	160
Stove - 2 burner	145
Porta Potti toilet with tie-down kit	145
20 gall.water tank with pump and sink connected	280
Anchor, chain and 40 metre line	86
Pop-top curtain	350
Navigation lights, interior lights, battery & switchboard	400
Multi-band colour scheme to hull	100
Yamaha 8 HP Longshaft motor	1,200
No. 1 Genoa	554
Spinnaker (tri-radial)	762
Mast, Boom & all rigging in kit form (STAGE A YACHT ONLY)	1,590

NOTE:

Prices quoted are delivered Melbourne and are inclusive of sales tax.
Prices and specifications are subject to change without notice.
Terms - 20% deposit with order, balance payable on delivery.